

Features

- ◇ 1.5 bellows, long stroke, suitable for handling workpiece with uneven and irregular surface.
- ◇ Split type fitting for suction cup, quick replacement of wearing parts, recyclable, significantly cost reduction.
- ◇ Heavy load design, suitable for handling heavy workpiece.

Applications

- ◇ Steel plate ◇ Wooden plate ◇ Heavy workpiece



How to order

SHB 40 N

① ② ③

① Series	② Diameter	③ Material & Hardness
SHB	40 – $\phi 40\text{mm}$	N – NBR 55 ★
	50 – $\phi 50\text{mm}$	WS – White silicone 50 ★
	63 – $\phi 63\text{mm}$	F – Fluorine rubber 65
	80 – $\phi 80\text{mm}$	
	100 – $\phi 100\text{mm}$	
	125 – $\phi 125\text{mm}$	

◇ Note: "★" – common material, in stock. For other materials, please consult with AIRBEST.

Technical parameters

Model	Pull-out force(N)	Inner volume (cm ³)	Recommended hose diameter(mm)
SHB40	56	15	8
SHB50	88	27	8
SHB63	140	45	8
SHB80	226	98	8
SHB100	353	240	10
SHB125	552	384	10

◇ Note: Testing vacuum level: -60kPa. Testing Workpiece: smooth and clean surface.
The data of pull-out force as above are figured out without considering safety factor. The data may be different according to different workpiece surfaces.

Dimensions(mm)

SHB40-125

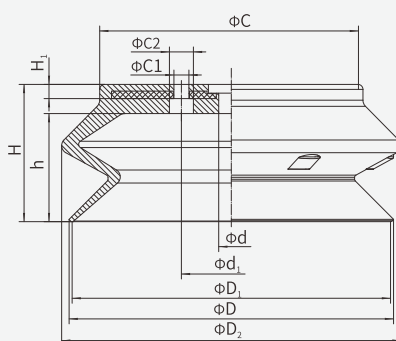

Model/Size	D	D ₁	D ₂	d	d ₁	H	H ₁	h	C	C ₁	C ₂
SHB40	41.5	40	43.2	6	18	20.5	3.5	13	30	3- $\phi 4$	3- $\phi 6.5$
SHB50	52	50	54	6	18	24	3.5	16.5	40.5	3- $\phi 4$	3- $\phi 6.5$
SHB63	65	63	67.5	8	34	31.5	4.5	21.5	50	4- $\phi 5$	4- $\phi 8$
SHB80	83	80	85	8	34	37	5	27.5	64	4- $\phi 5$	4- $\phi 8$
SHB100	103	100	106.5	10	40	47.5	6	35.5	80	4- $\phi 6$	4- $\phi 9.5$
SHB125	128.5	125	135	10	40	56	6	44	105	4- $\phi 6$	4- $\phi 9.5$